



**Space Business Co-Creation Platform**

**cross U**

***Our Services***

The space industry is attracting attention as an innovative field with a wide range of adjacent areas.

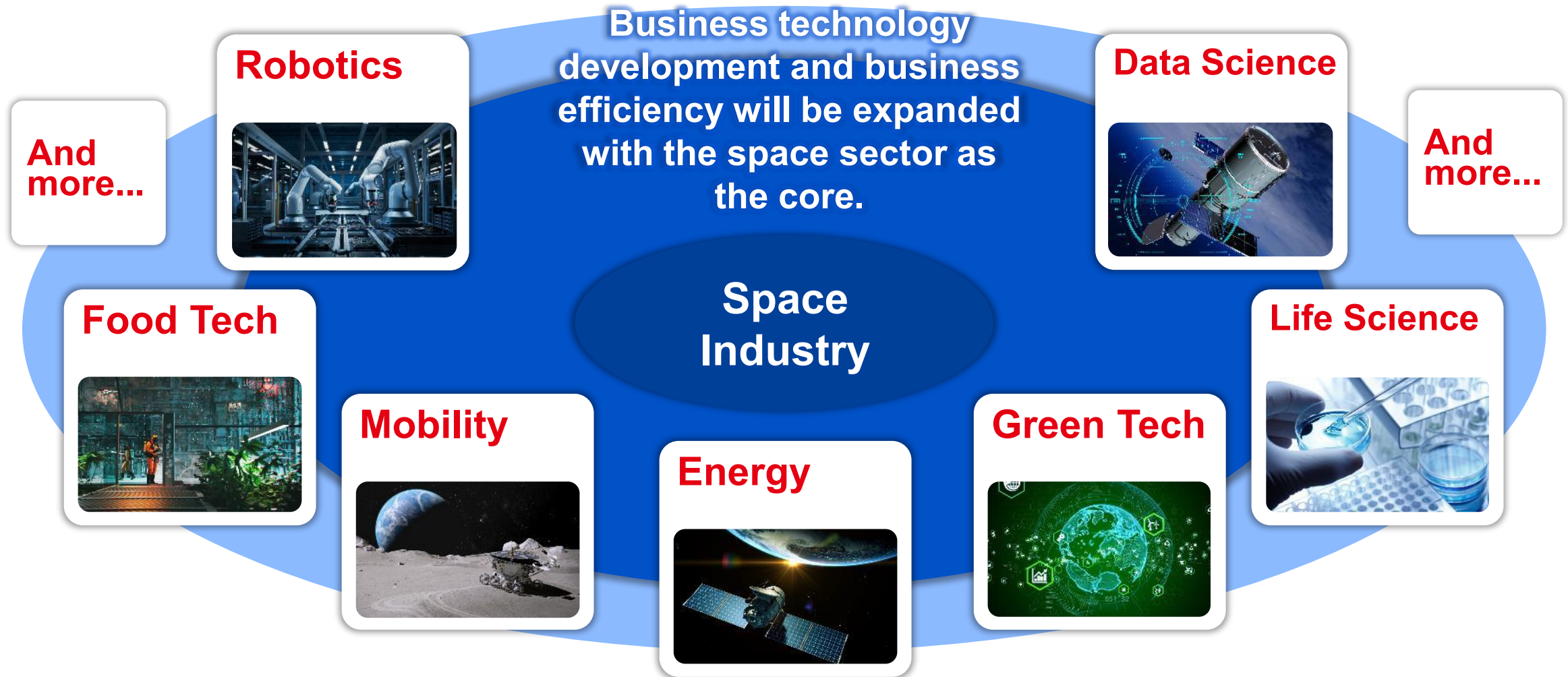

The global space business market size was approximately 50 trillion yen\*<sup>1</sup> in 2020. In Japan, the market is expected to expand further as well, with government support of up to 1 trillion yen in the form of the "Space Strategy Fund" starting in FY 2024

The global space business market continues to grow and is predicted to reach 150 trillion yen by 2040

The Global Space Business Market (Trillion dollars)

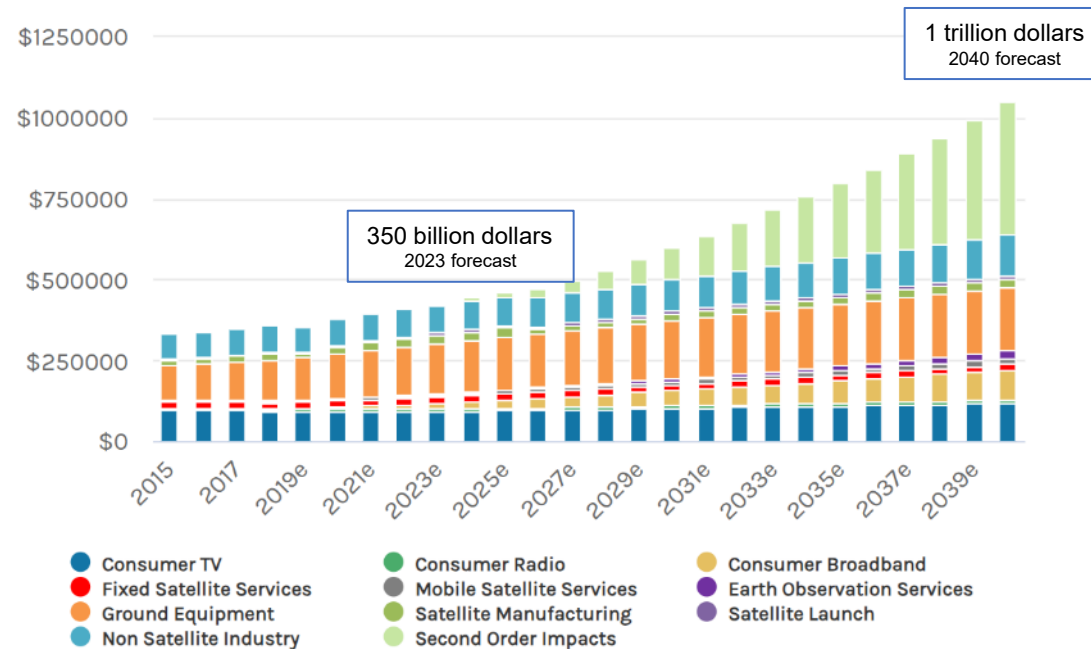

Source: Haver Analytics, Morgan Stanley Research forecasts

Space Strategy Fund launched.

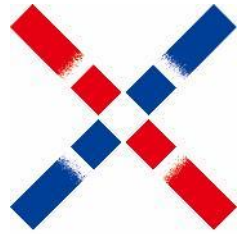

cross U

Players in various fields become space players

## Space Business Co-Creation Platform



and more



### Agriculture

Automation of agricultural machinery using satellites, agricultural land management, etc.



### Environment, Resources

Certification and issuance of forest credits, global environmental monitoring and forecasting, etc.

Space 



### Construction, Civil Engineering & Infrastructure

Advanced drone surveying, automation of construction equipment, etc.



### Information & Communication

Resolving issues in further wide-area utilization of communications satellites, etc.



and more



and more



### Insurance

Expansion of InsureTech and its use in insurance operations, etc.



### Logistics

Addressing driver shortages, satellite applications for automated driving, etc.



### Entertainment, Leisure

Expansion of space travel, entertainment production in space, etc.



### Manufacturing

Materials research in space, understanding supply chains using satellites, etc.



### Pharmaceuticals, Medical Care

Experiments and research in space, etc.



and more

**cross U facilitates connecting  
non-space companies and organizations with those in the space industry**



Providing "places" and a "community" to create innovation in space-related businesses.

## Providing places

We offer a variety of "places" to accelerate the space business



## Building a community

We provide business matching, events, programs, etc.



Supporting business expansion by building an ecosystem that brings the latest knowledge and information together with domestic and international space-related players from industry, government, and academia

**Gather**



Companies, start-ups, and academia involved in the space business gather from Japan and overseas.

**Connect**



That gathering will attract players in the areas surrounding the space business and promote a wide range of exchanges and spreading of information.

**Co-create**



Accelerators and VCs will also gather to integrate cutting-edge technology and create a variety of businesses.

**Expand**



Innovation will accelerate and business fields in space-related areas will expand into various other areas.

Nihonbashi is a geographically very convenient place for access to the major areas of Tokyo.



Our objective is to establish a comprehensive network of industry, academic, research, and government entities across all sectors to foster collaboration and knowledge exchange in the space industry.

We facilitate exchanging members and sharing information through co-hosted events, sponsored events, and announcements.

Number of special members:

**329\***

Companies/  
organizations/  
individuals

Event track record  
for 2024

**311** activities

Percentage of members  
in non-space areas

Approx. **70** %

\* As of August 2025





The events bring together a diverse group of companies and new business leaders seeking information and contacts to commercialize the space industry. We encourage active interaction through the use of our facilities and events.

## Examples of cross U special members

### General companies



### Startups



### Academia, local governments, organizations, etc.



## Breakdown of special memberships (As of August 2025)

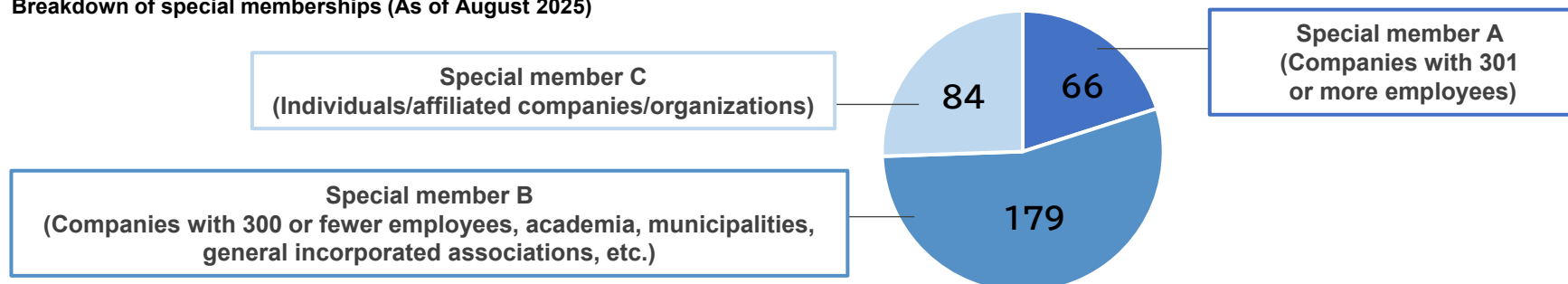



We promote cooperation with domestic organizations and associations, and with special-member municipalities and academic institutions as well. We will continue to expand our circle of cooperation both domestically and internationally.

(As of June 2024)



National Research and Development Agency  
Japan Aerospace Exploration Agency  
[Partnership agreement]



The University of Tokyo Graduate School  
Department of Aeronautics and Astronautics in the  
School of Engineering



cross U provides X-NIHONBASHI TOWER and BASE, which offer a variety of spaces for various occasions, including conference spaces, meeting rooms, co-working spaces, for exchange and co-creation among people aiming to expand the space business and create innovation.

## Conference Spaces\*



Events can be held for up to 150 people (up to 40 people for BASE).

**TOWER**  
**BASE**

## Co-Working Spaces



The conference spaces can be used as co-working spaces when not in use for events.

**TOWER**  
**BASE**

## Meeting Spaces\*



**TOWER**  
**BASE**

## Shared Rooms



Shared rooms available for temporary occupancy and corporate registration.  
Note: A separate contract with Mitsui Fudosan is required.

**BASE**

## Web Conference Booths



**BASE**

## Individual Working Booths



**BASE**

## Exhibition Space\*



**BASE**

## Bar Lounge\*



**BASE**

\* Occupancy and other restrictions apply depending on membership type.  
For details, see page19.





**X-NIHONBASHI TOWER** has a conference space that can accommodate events for up to 150 people, offering a flexible space for a variety of uses.

 Nihonbashi Muromachi 2-1-1, Chuo City, Tokyo Metropolis  
7<sup>th</sup> floor of Nihonbashi Mitsui Tower

 Direct connection from Exit A7/A8 of Mitsukoshimae Station on the Tokyo Metro Ginza Line  
3-minute walk from the JR Sobu Line Rapid Train Shin-Nihonbashi Station

**Entrance**

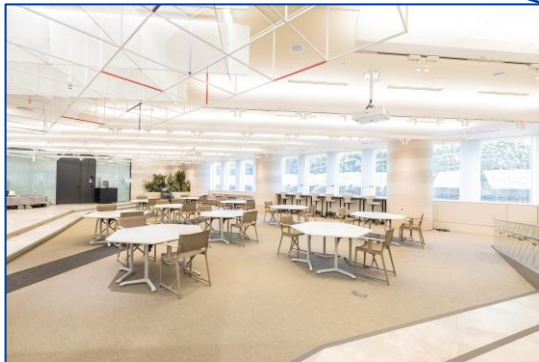
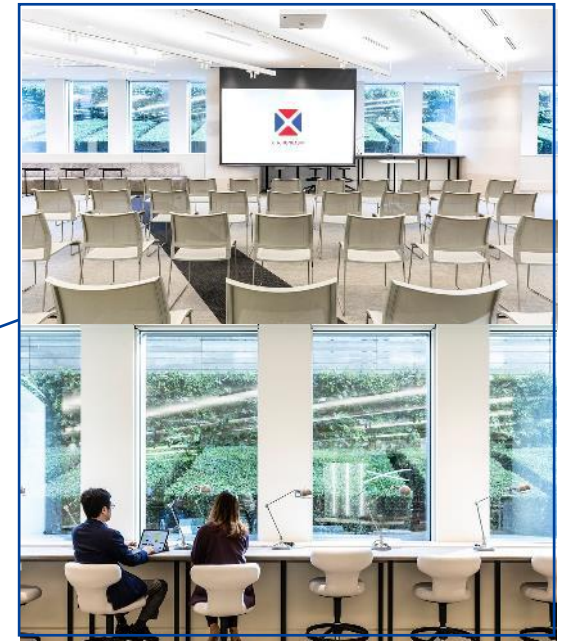
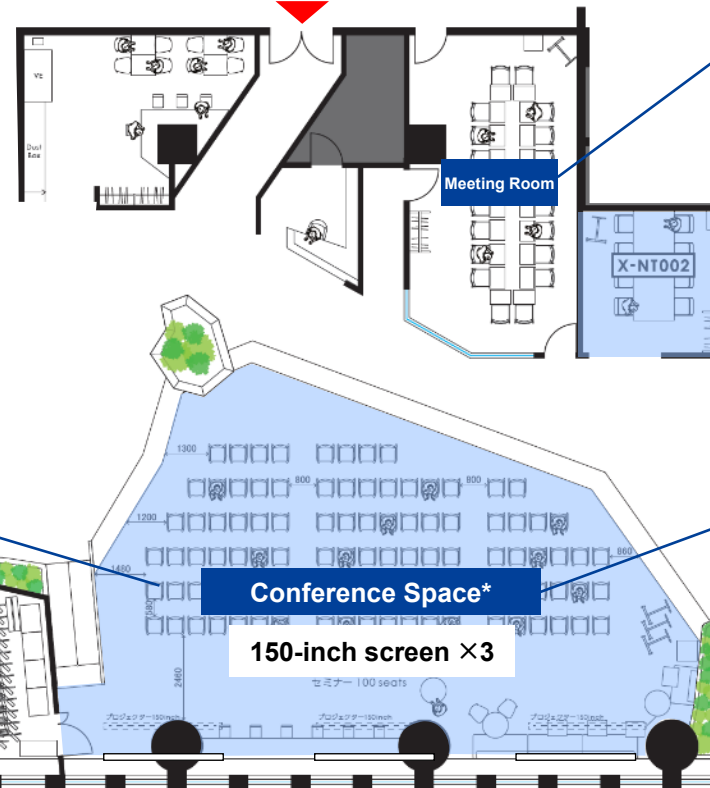

\* The conference space can be used as a co-working space when not in use for events.





**X-NIHONBASHI BASE** is equipped with a conference space that can host events for up to 40 people and a bar lounge for networking and a variety of other uses.



Nihonbashi Muromachi 3-3-9, Chuo City, Tokyo Metropolis  
3rd and 4th floor of Nihonbashi IT Building



1-minute walk from Mitsukoshimae Station on the Tokyo Metro Ginza Line and Hanzomon Line  
2-minute walk from JR Shin-Nihonbashi Station  
Use Exit A10 from either station

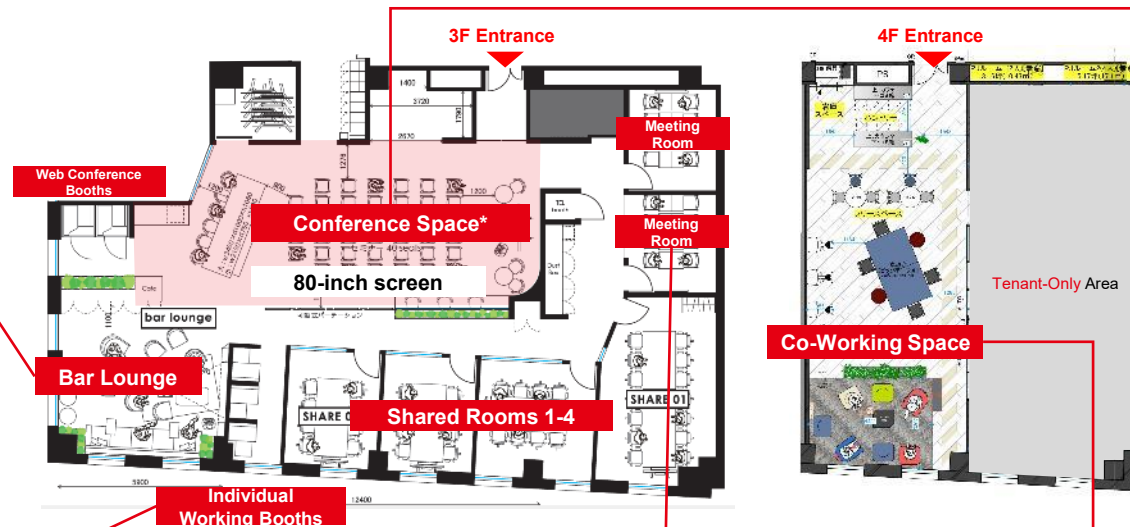

\* The conference space can be used as a co-working space when not in use for events.







**X-NIHONBASHI TOWER**

- 国立研究開発法人 宇宙航空研究開発機構
- 宇宙サービスイノベーションラボ 事業協同組合
- iSpace Mission Control Center

**X-NIHONBASHI BASE**

一般社団法人クロスユー

Qammer株式会社	一般社団法人ABLab
一般社団法人Space Port Japan	一般社団法人宇宙美容機構
一般社団法人宇宙旅客輸送推進協議会	一般社団法人ニュースベース国際戦略研究所
株式会社ElevationSpace	株式会社Everimpact Japan
株式会社SPACE BEAUTY LAB	株式会社岩谷技研
株式会社バスキュール	トヨタ自動車株式会社

**Other Companies and Facilities:**

- 株式会社アクセルスペース
- 株式会社ボーラスター・スペース
- Beyond Next Ventures株式会社
- 宇宙システム開発株式会社
- 稲畑産業株式会社
- avatarin株式会社
- Frontier Innovations株式会社
- 一般社団法人ライフサイエンス・イノベーション・ネットワーク・ジャパン
- 三井不動産株式会社
- 新日本橋駅
- 小伝馬町駅
- 馬喰横山駅
- 東日本橋駅
- NTKインターナショナル株式会社
- 浜町駅
- 新日本空調株式会社
- 株式会社ispace
- ユニデンホールディングス株式会社
- 株式会社ジューコモ
- 国立研究開発法人 宇宙航空研究開発機構
- Axiom Space
- Space BD株式会社
- 株式会社アークエッジ・スペース
- 東レ株式会社
- 株式会社日本低軌道社中
- 株式会社ラグラボ
- 損害保険ジャパン株式会社
- 株式会社天地人
- 将来宇宙輸送システム株式会社
- 日鉄ケミカル&マテリアル株式会社
- 三菱倉庫株式会社
- 株式会社日本旅行
- 水天宮駅
- 東京メトロ日比谷線
- 東京メトロ東西線

(2024年8月末時点)

(2024年8月末時点)

From **Nihonbashi**

Mitsukoshimae Station

Shin-Nihonbashi Station

Directly  
connected to  
**Nihonbashi Mitsui  
Tower**

Nihonbashi Station

About 8 minutes'  
walk from Nihonbashi  
**Mitsui Tower**

To Otemachi Station	About 1 minute	Use Mitsukoshimae Station on the Tokyo Metro Hanzomon Line
To Roppongi Station	About 14 minutes	Use Mitsukoshimae Station on the Tokyo Metro Ginza Line and transfer to the Hibiya Line at Ginza Station
To Shibuya Station	About 18 minutes	Use Mitsukoshimae Station on the Tokyo Metro Hanzomon Line
To Akihabara Station	About 3 minutes	Use Mitsukoshimae Station on the Tokyo Metro Ginza Line and transfer to the JR Yamanote Line at Kanda Station
To Kasumigaseki Station	About 7 minutes	Use Mitsukoshimae Station on the Tokyo Metro Ginza Line and transfer to the Hibiya Line at Ginza Station
To Shinagawa Station	About 15 minutes	Use the direct access from Nihonbashi Station on the Toei Asakusa Line to the Kaitoku Keihin Kyuko Line
To Yokohama Station	About 36 minutes	Use Shin-Nihonbashi Station on the JR Sobu Rapid Line
To Haneda Airport Station	About 38 minutes	Use the direct access from Nihonbashi Station on the Toei Asakusa Line to the Kaitoku Keihin Kyuko Line
To Narita Airport Station	About 64 minutes	Use the Airport Kaitoku Express from Nihonbashi Station on the Toei Asakusa Line

To Nagoya Station	About 97 minutes	Use the Tokaido Shinkansen Nozomi
To Shin-Osaka Station	About 147 minutes	Use the Tokaido Shinkansen Nozomi
To Sendai Station	About 90 minutes	Use the Tohoku Shinkansen Hayabusa

From Tokyo

Tokyo Station

About 8 minutes' walk from  
Nihonbashi Mitsui Tower

Various events and programs to promote the expansion of the space business are held about 300 times a year,\* and cooperation and co-creation among special members are actively pursued.

\* Actual track record for FY 2023

## ■ Nihonbashi Space Week (NSW 2025 Oct. 28th – 31st, 2025 @ Nihonbashi)

One of Asia's largest space business events, held annually since 2021.

In the Nihonbashi area, where many space players are clustered together, various events are held intensively, including business exhibitions, conferences of various sizes, contests, and networking.

NIHONBASHI  
SPACE WEEK

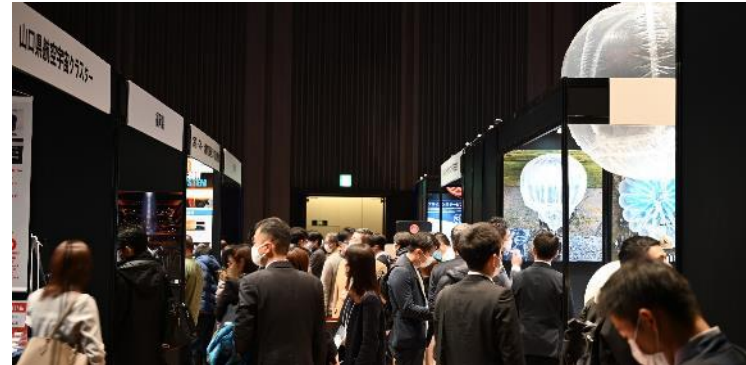



## ■ Networking events



## ■ Business matching events

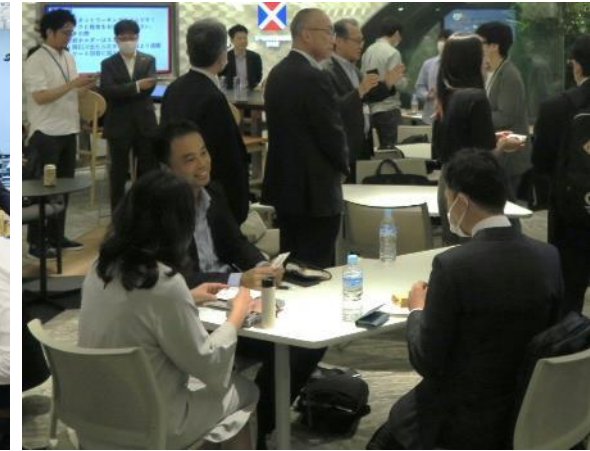

## ■ Seminars and symposiums



## ■ Space business courses

**Overview of **space** development utilization and **space business** and basics of satellite design**

**Course schedule** From December 2023 to February 2024  
Total of 6 sessions: 19:00-20:30

**Venue** X-NIHONBASHI BASE  
3rd Floor, Nihonbashi IT Building Nihonbashi Muromachi 3-3-9, Chuo City, Tokyo Metropolis

Organized by cross U



cross U Academy:  
Lectures in space  
development and  
business by guest  
experts





We are expanding our international network .

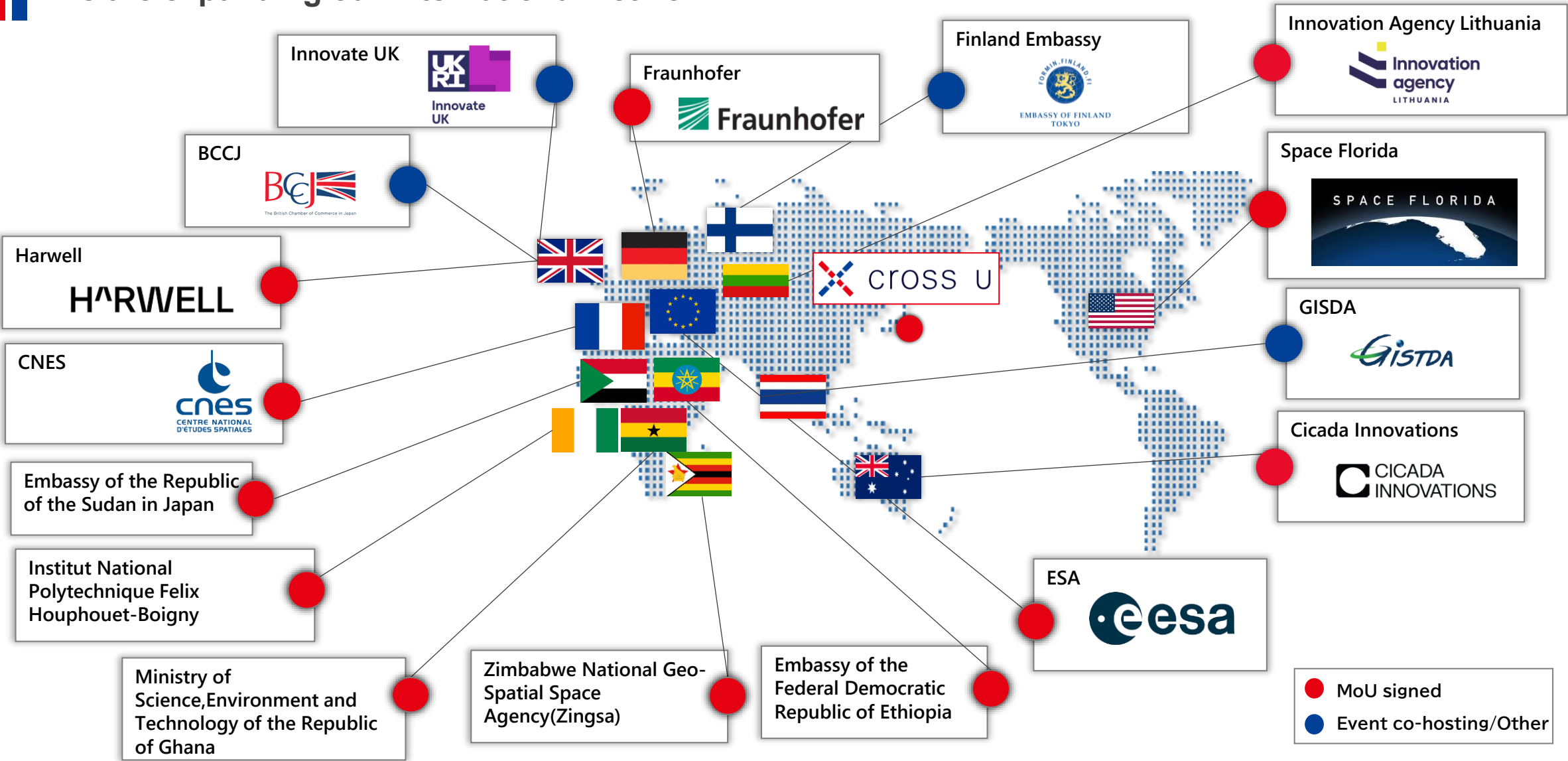

※As of September 2025

The committee includes representatives from a diverse range of organizations, including long-established corporations and academic institutions.

## Directors and Auditors

President of the Board	Shinichi Nakasuka	Professor, Graduate School of Engineering, The University of Tokyo
Vice-President of the Board	Takashi Ueda	President and Representative Director, Mitsui Fudosan Co., Ltd
Director	Shuzo Takada	Corporate Vice President, FUJIFILM Corporation Former Director General of National Space Policy Secretariat, Cabinet Office (NSPS)
Director	Nobuyuki Fujisawa	General Manager, Space Business Innovation Department Innovation Promoting Division, MITSUI FUDOSAN CO., LTD.
Auditor	Yutaro Kikuchi	Attorney at law, Kikuchi Sogo Law Office
Auditor	Shigeru Sugimoto	CEO, Crowe Sakura & Co.

## Secretariat

Secretary-General	Masafumi Yonazu
-------------------	-----------------

## Administrative Advisory Committee

Tohru Akaura	General Partner & Co-Founder, Incubate Fund Co., Ltd. Special Advisor, Japan Venture Capital Association.
Masayasu Ishida	Director, A.T. Kearney K.K.
Seiji Izumisawa	Chairman of the Board, Mitsubishi Heavy Industries, Ltd.
Takashi Ichikawa	Senior General Manager, Space Systems Division, Defense & Space Systems Group, Mitsubishi Electric Corporation
Shin Okuno	Vice President, Japan Aerospace Exploration Agency(JAXA)
Naoto Kadowaki	Principal Researcher, National Institutes of Information and Communications Technology
Masanobu Komoda	Chairman of the Board, Mitsui Fudosan Co., Ltd.
Kenji Goto	President, COO, Japan Space Systems
Motomitsu Shimizu	Managing Director Aerospace Business Division Aerospace and National Security Business Unit, NEC Corporation
Mengu Cho, Ph.D	Professor, Faculty of Engineering Department of Space Systems, Engineering Kyushu Institute of Technology Professor, Department of Innovative Mechanical and Electronic Engineering Chiba Institute of Technology
Saku Tsuneta, Ph.D.	Director Astronomy Research Center, Chiba Institute of Technology
Shinji Tokumasu, Ph.D.	Vice President, National Institute of Advanced Industrial Science and Technology
Tsugio Mitsuoka	Director and Chairman of the Board, IHI
Naoko Yamazaki	Astronaut, Representative Director, Space Port Japan Association
Dr. Hiroo Yugami	Executive Vice President for the Science Park, Disaster Reconstruction and Regeneration, and Nano Terasu Co-creation, Tohoku University
Toshiya Watanabe	Vice President, Institute of Science Tokyo



We have startup CEOs and researchers who are experts in the space business supporting our activities.



**Hidetaka Aoki**  
Space Business Evangelist  
Partner, Global Brain Corporation  
Director, Space Port Japan Association



**Yoshifumi Inatani**  
Representative Director,  
Space Liner Association



**Fuminori Kataoka**  
Project General Manager,  
Lunar Exploration Mobility Works  
Project,  
TOYOTA MOTOR CORPORATION  
Advanced R&D and Engineering  
Company



**Tomoya Nakamura**  
Representative Director and CEO,  
Axelspace Corporation



**Takayoshi Fukuyo**  
CEO and Representative Director,  
ArkEdge Space Inc.



**Yuichi Yamaura**  
Visiting Professor, University of  
Tsukuba  
Former Director, Japan  
Aerospace Exploration Agency  
(JAXA)



**Masatoshi  
Nagasaki**  
President and Co-Founder,  
Space BD Inc.



**Satoshi Kurosu**  
Executive Mentor,  
Space Business Development  
Office,  
Yokogawa Electric  
Corporation



**Souichiro Kozuka**  
Professor,  
Faculty of Law,  
Gakushuin University



**Naohiko Kotake**  
Professor,  
Graduate School of System  
Design and Management,  
Keio University



**Seiko Shirasaka**  
Professor,  
Graduate School of System  
Design and Management,  
Keio University



**Kojiro Hatada**  
President and CEO,  
Innovative Space Carrier Inc.



**Naomi Kurahara**  
Co-Founder and CEO,  
Infostellar Inc.



**Toshinori Kuwahara**  
Associate Professor,  
Department of Aerospace  
Engineering,  
Graduate School of Engineering,  
Tohoku University



**Hiroshi Koyama**  
Chief Technical Officer,  
Defense & Space Systems  
Sector,  
Mitsubishi Electric Corporation



**Yasutoshi  
Hyakusoku**  
COO and Founder,  
Tenchijin, Inc.



**Akira Fukabori**  
Representative Director and  
CEO,  
avatarin Inc.



**Ayako Matsumoto**  
Manager, Space Business  
Development - Corporate  
Strategy  
ANA HOLDINGS INC.





**Teruo Yamashita**  
Board Director, Managing Executive Officer,  
Unit President,  
Space Business Unit,  
SKY Perfect JSAT Corporation



**Michael Fletcher**  
President and CEO,  
MJF Consulting LLC



**Koichi Wakata**  
Astronaut  
Chief Technology Officer,  
Axiom Space

	<b>Special member A</b>  <b>Corporations</b> Companies with 301 or more employees	<b>Special member B</b>  <b>Academia, startups, public organizations, etc.</b> Non-profit organizations,* <sup>2</sup> universities, school corporations, public interest corporations, diplomatic missions in Japan, local governments, etc.	<b>Special member C</b>  <b>Individuals</b>
Use of X-NIHONBASHI facilities* <sup>3</sup>	<ul style="list-style-type: none"> <li>● Use of co-working spaces, bar lounge, etc.</li> <li>● Occupancy use of co-working spaces, bar lounge, etc. (events, etc.)</li> <li>● Gallery exhibitions</li> <li>● Use of conference spaces</li> </ul>		<ul style="list-style-type: none"> <li>● Use of co-working spaces, bar lounge, etc.</li> <li>● Gallery exhibitions</li> <li>● Use of conference spaces</li> </ul>
Registration fee	50,000 yen	20,000 yen	2,000 yen
Annual Membership fee	250,000 yen	60,000 yen	5,000 yen
Number of Bitkey accounts	10* <sup>4</sup>	5* <sup>5</sup>	1* <sup>6</sup>

\*1. The number of full-time employees.

\*2. Excluding Incorporated Administrative Agencies, National Research and Development Agencies, and Administrative Agencies (local governments).

\*3. X-NIHONBASHI facilities are available from 8:00 to 19:00.

Additional fees will be charged separately for full, partial, and occupancy use of the facilities. Please refer to the separate document for details.

\*4. Up to 10 additional keys can be issued for a fee.

\*5. Up to 5 additional keys can be issued for a fee.

\*6. X-NT fixed-lease tenants (≠ Nihonbashi members) have no limit on the number of accounts that can be issued.

		Special member A/B	Of which, Nihonbashi members*1	Special member C
Co-working spaces: TOWER/BASE	Use*2	Available	Available	Available
	Occupancy*3	Up to <b>4 times a year</b> at each location Reservation possible <b>3 months in advance</b>	Up to <b>12 times a year</b> at each location Reservation possible <b>6 months in advance</b>	Not available
Bar lounge: BASE	Use*2	Available	Available	Available
	Occupancy*3	Up to <b>4 times a year</b> Reservation possible <b>1 month in advance</b>	Up to <b>12 times a year</b> Reservation possible <b>2 months in advance</b>	Not available
Use of conference spaces		Free of charge up to <b>30 hours/month</b> After that, 250 yen/10 min	Free of charge up to <b>50 hours/month</b> After that, 250 yen/10 min	Free of charge up to <b>30 hours/month</b> After that, 250 yen/10 min
Use of Meeting Space 002 (TOWER, reservation not possible, no doors)		Available	Available	Available
Gallery exhibitions (BASE)		<b>Available up to twice a year</b> <b>in 2-week periods</b>	<b>Available up to 5 times a year</b> <b>in 2-week periods</b>	Not available
Shared rooms: 4 rooms*4		Separate contract with Mitsui Fudosan required (Membership registration required) 31,000 yen (monthly, consumption tax included)	Same as on the left	Not available

X-NIHONBASHI facilities are available for use from 8:00 to 19:00, except for the shared rooms.  
Additional fees will be charged separately for full, partial, and occupancy use of the facilities.  
Please refer to the separate document for details.

- \*1. Companies with space-related business divisions based in the Nihonbashi area are eligible.
- \*2. May not be available during events, etc.
- \*3. There is a pre-screening process for using the co-working spaces for events. We also ask that you refrain from using the spaces for commercial purposes.
- \*4. Please refer to the next page for information on the shared rooms.



Shared rooms are available at X-NIHONBASHI BASE for unlimited use by the hour, and can be used for meetings, etc.



Note:

- To use this service, a separate contract with Mitsui Fudosan is required in addition to becoming a cross U member.
- Additional fees will be charged for the use of shared rooms.
- The use time is unlimited. (A reservation must be made via the dedicated website to use them.)
- Registration as a corporation is also available upon request.

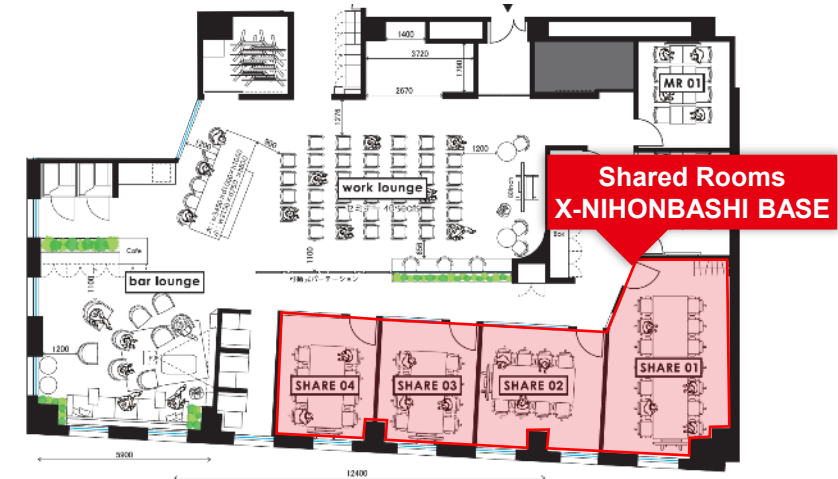

SHARE 01	30.00 m <sup>2</sup>	14 people
SHARE 02	19.50 m <sup>2</sup>	8 people
SHARE 03	15.57 m <sup>2</sup>	8 people
SHARE 04	15.38 m <sup>2</sup>	8 people

- Open hours: 24 hours a day, including Saturdays, Sundays, and national holidays (except when the facility is closed)
- Rental equipment: 1 monitor  
1 table  
8 chairs  
1 whiteboard
- Amenities: Power supply Wi-Fi

(As of April 2023)

Note: Please be aware that the equipment and amenities are subject to change without notice.

