



**Space Business Co-Creation Platform**

**cross U**

***Our Services***

The space industry is attracting attention as an innovative field with a wide range of adjacent areas.

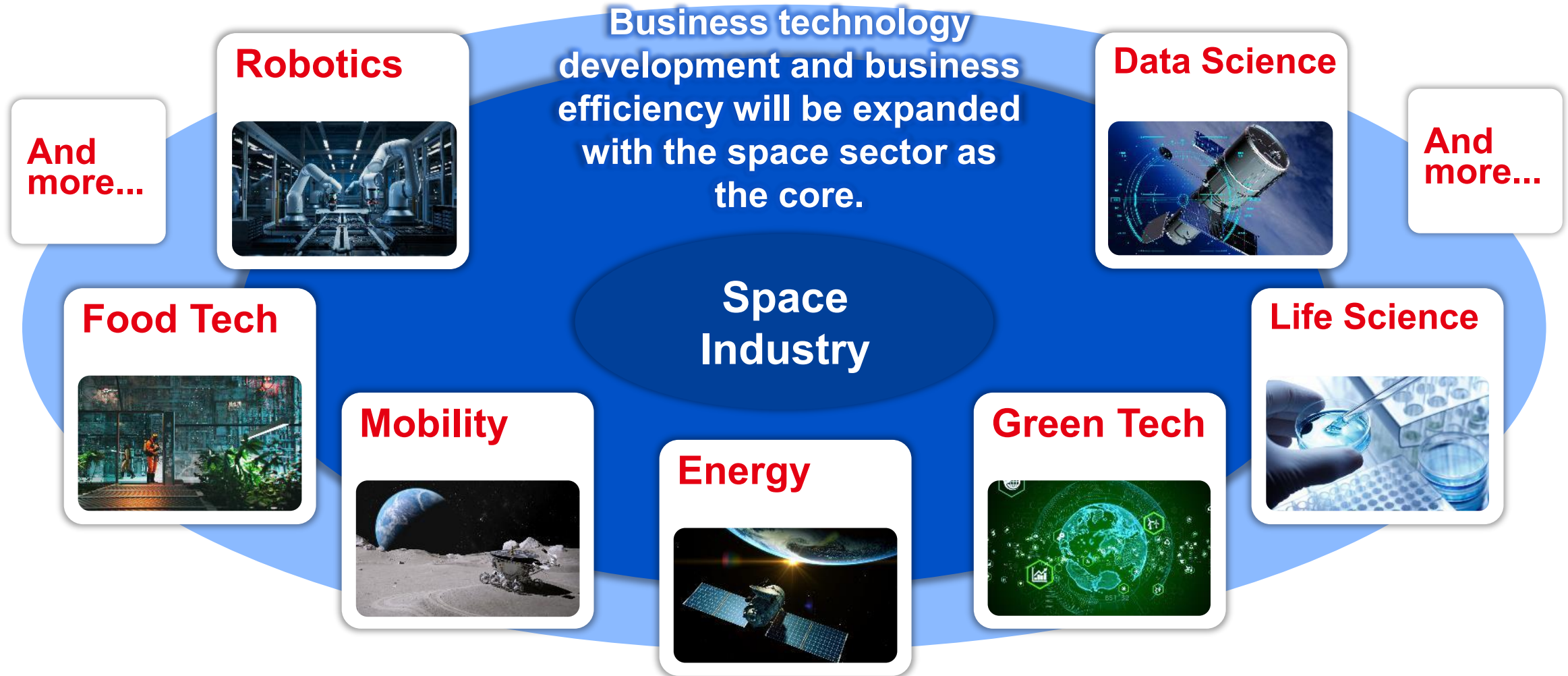

The global space business market size was approximately 50 trillion yen\*<sup>1</sup> in 2020. In Japan, the market is expected to expand further as well, with government support of up to 1 trillion yen in the form of the "Space Strategy Fund" starting in FY 2024

The global space business market continues to grow and is predicted to reach 150 trillion yen by 2040

The Global Space Business Market (Trillion dollars)

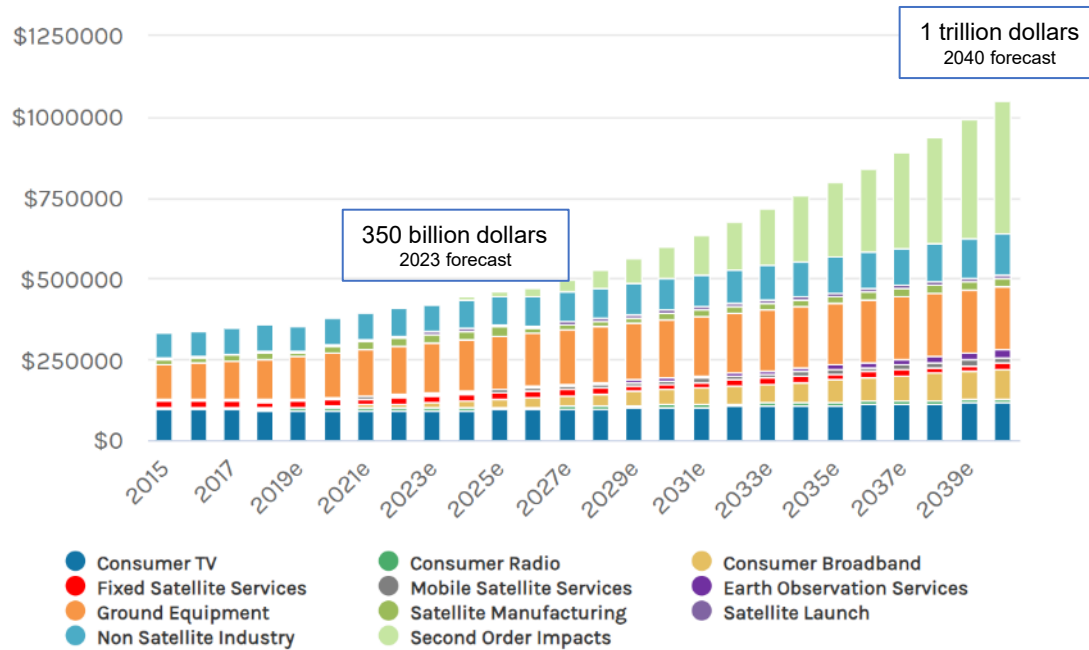

Source: Haver Analytics, Morgan Stanley Research forecasts

Space Strategy Fund launched.

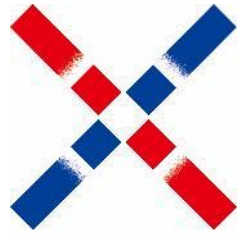

CROSS U

Players in various fields become space players

## Space Business Co-Creation Platform



and more



### Agriculture

Automation of agricultural machinery using satellites, agricultural land management, etc.



### Environment, Resources

Certification and issuance of forest credits, global environmental monitoring and forecasting, etc.

Space 



### Construction, Civil Engineering & Infrastructure

Advanced drone surveying, automation of construction equipment, etc.



### Information & Communication

Resolving issues in further wide-area utilization of communications satellites, etc.



and more



and more



### Insurance

Expansion of InsureTech and its use in insurance operations, etc.



### Logistics

Addressing driver shortages, satellite applications for automated driving, etc.



### Entertainment, Leisure

Expansion of space travel, entertainment production in space, etc.



### Manufacturing

Materials research in space, understanding supply chains using satellites, etc.



### Pharmaceuticals, Medical Care

Experiments and research in space, etc.



and more

**cross U facilitates connecting non-space companies and organizations with those in the space industry**



Providing "places" and a "community" to create innovation in space-related businesses.

## Providing places

We offer a variety of "places" to accelerate the space business

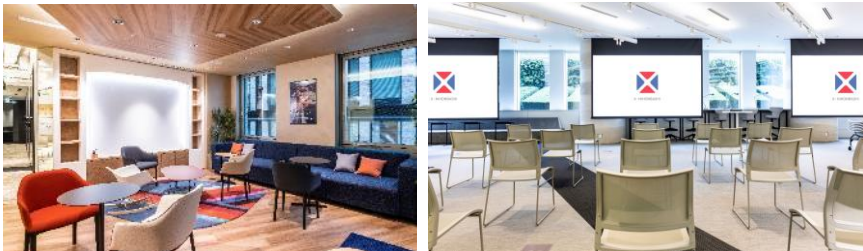

## Building a community

We provide business matching, events, programs, etc.



Supporting business expansion by building an ecosystem that brings the latest knowledge and information together with domestic and international space-related players from industry, government, and academia

**Gather**

Companies, start-ups, and academia involved in the space business gather from Japan and overseas.

**Connect**

That gathering will attract players in the areas surrounding the space business and promote a wide range of exchanges and spreading of information.

**Co-create**

Accelerators and VCs will also gather to integrate cutting-edge technology and create a variety of businesses.

**Expand**

Innovation will accelerate and business fields in space-related areas will expand into various other areas.

Nihonbashi is a geographically very convenient place for access to the major areas of Tokyo.



Our objective is to establish a comprehensive network of industry, academic, research, and government entities across all sectors to foster collaboration and knowledge exchange in the space industry. We facilitate exchanging members and sharing information through co-hosted events, sponsored events, and announcements.

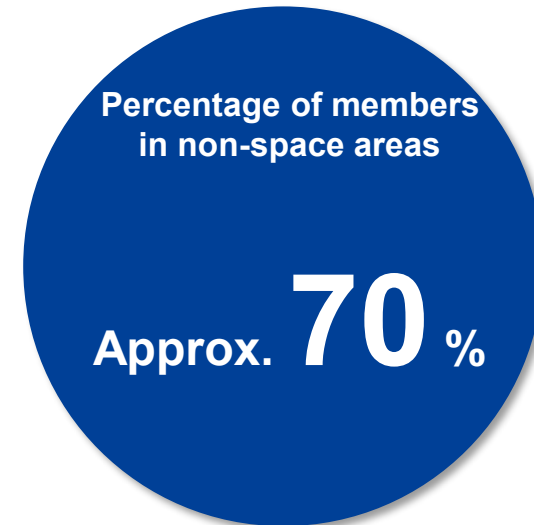

\* As of April 2026

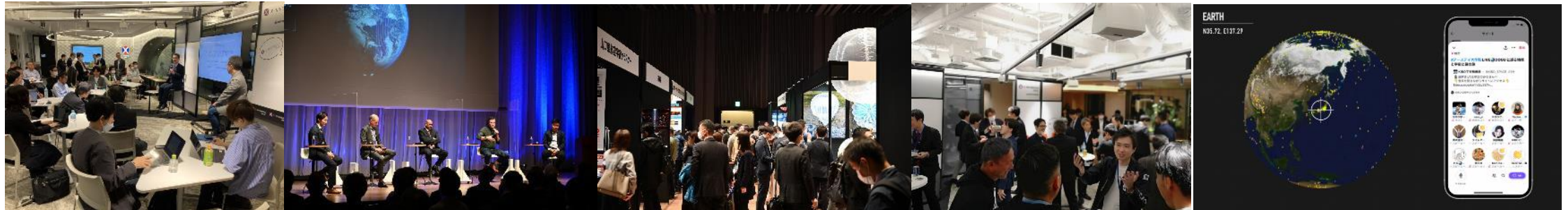

The events bring together a diverse group of companies and new business leaders seeking information and contacts to commercialize the space industry. We encourage active interaction through the use of our facilities and events.

## Examples of cross U special members

### General companies

### Startups

### Academia, local governments, organizations, etc.

Breakdown of special memberships (As of April 2026)

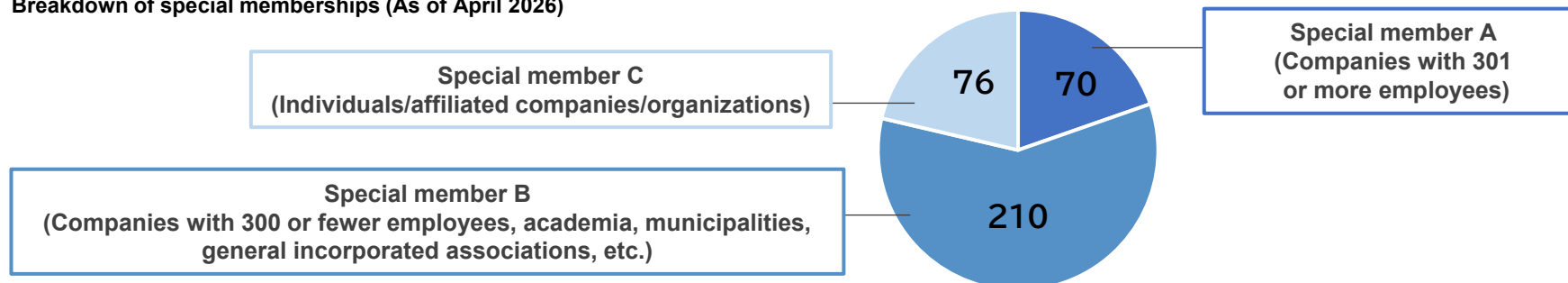

We promote cooperation with domestic organizations and associations, and with special-member municipalities and academic institutions as well. We will continue to expand our circle of cooperation both domestically and internationally.

(As of June 2024)



エスネット福岡  
Fukuoka Prefectural Robotics & Advanced System Industry Development Council

Yamaguchi Aerospace Cluster  
山口県航空宇宙クラスター  
Yamaguchi Aerospace Cluster  
(Yamaguchi Industrial Promotion Foundation)

The Ritsumeikan Trust

National University Corporation Tohoku University

National Research and Development Agency  
Japan Aerospace Exploration Agency  
[Partnership agreement]

茨城県  
Ibaraki Prefecture

国立大学法人  
九州工業大学  
National University Corporation  
Kyushu Institute of Technology

北九州市  
CITY OF KITAKYUSHU  
Kitakyushu City

Saitama Prefectural  
Urawa High School

一般社団法人  
日本航空宇宙学会  
The Japan Society for Aeronautical and Space Sciences

SPACEPORT  
OITA  
Oita Prefecture

Kanagawa Prefecture

東京大学  
国際オープンイノベーション機構  
Institute for Open Innovation  
The University of Tokyo  
Institute for Open Innovation

Intelligent Space Systems Laboratory  
University of Tokyo  
ISSL

The University of Tokyo Graduate School  
Department of Aeronautics and Astronautics in the  
School of Engineering

鹿児島県  
Kagoshima Prefecture

国立研究開発法人  
情報通信研究機構  
National Institute of Information and  
Communications Technology

日本貿易振興機構(ジェトロ)  
Japan External Trade Organization (JETRO)

Keio University  
Graduate School of System Design and Management

cross U provides X-NIHONBASHI TOWER and BASE, which offer a variety of spaces for various occasions, including conference spaces, meeting rooms, co-working spaces, for exchange and co-creation among people aiming to expand the space business and create innovation.

## Conference Spaces\*



Events can be held for up to 150 people (up to 40 people for BASE).

**TOWER**  
**BASE**

## Co-Working Spaces



The conference spaces can be used as co-working spaces when not in use for events.

**TOWER**  
**BASE**

## Meeting Spaces\*



**TOWER**  
**BASE**

## Shared Rooms



Shared rooms available for temporary occupancy and corporate registration.  
Note: A separate contract with Mitsui Fudosan is required.

**BASE**

## Web Conference Booths



**BASE**

## Individual Working Booths



**BASE**

## Exhibition Space\*



**BASE**

## Bar Lounge\*



**BASE**

\* Occupancy and other restrictions apply depending on membership type. For details, see page 19.



**X-NIHONBASHI TOWER** has a conference space that can accommodate events for up to 150 people, offering a flexible space for a variety of uses.

Nihonbashi Muromachi 2-1-1, Chuo City, Tokyo Metropolis  
7<sup>th</sup> floor of Nihonbashi Mitsui Tower

Direct connection from Exit A7/A8 of Mitsukoshimae Station on the Tokyo Metro Ginza Line  
3-minute walk from the JR Sobu Line Rapid Train Shin-Nihonbashi Station

**Entrance**

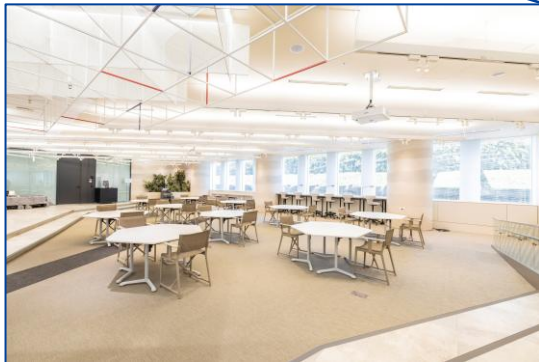
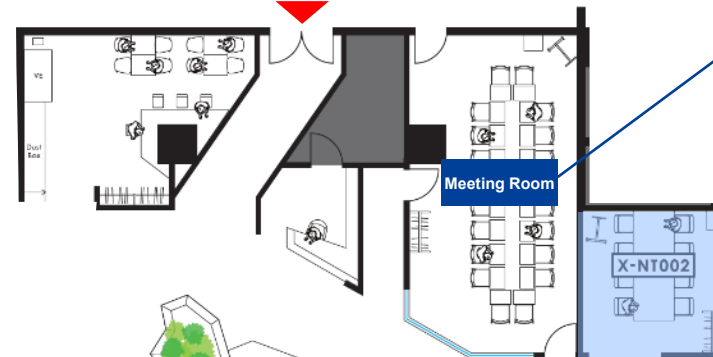

\* The conference space can be used as a co-working space when not in use for events.

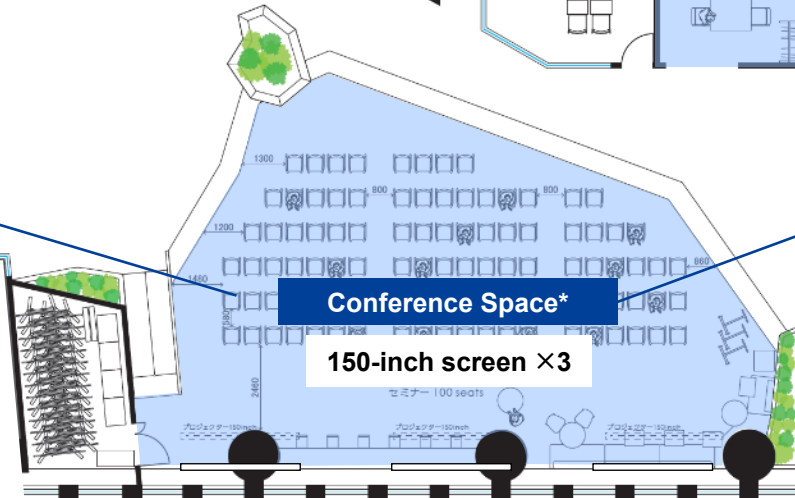



**X-NIHONBASHI BASE** is equipped with a conference space that can host events for up to 40 people and a bar lounge for networking and a variety of other uses.

Nihonbashi Muromachi 3-3-9, Chuo City, Tokyo Metropolis  
3rd and 4th floor of Nihonbashi IT Building

1-minute walk from Mitsukoshimae Station on the Tokyo Metro Ginza Line and Hanzomon Line  
2-minute walk from JR Shin-Nihonbashi Station  
Use Exit A10 from either station

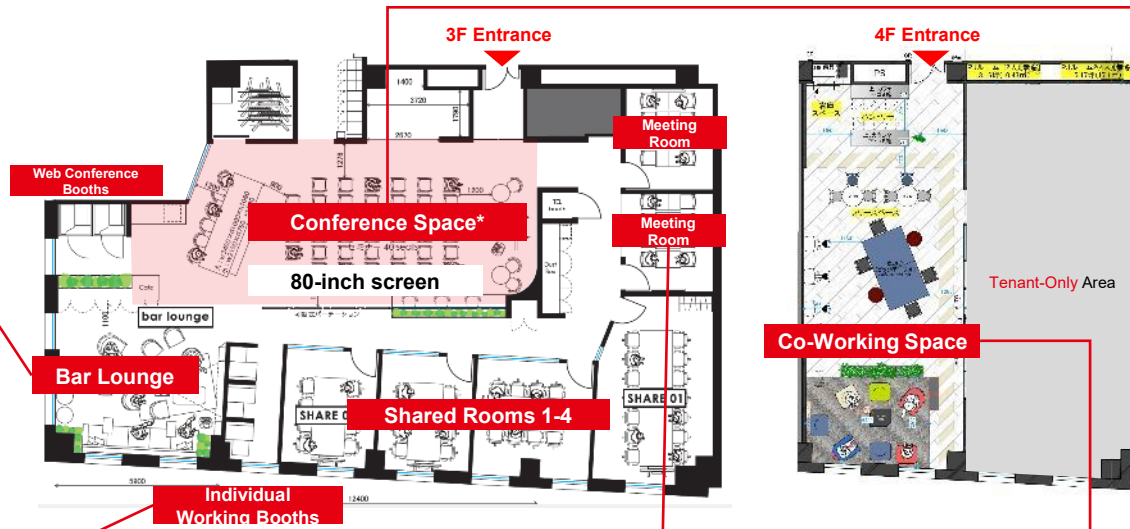

\* The conference space can be used as a co-working space when not in use for events.

Nihonbashi has been attracting challengers from all over Japan and creating new values since the Edo era. Following in the footsteps of the life science sector, cross U has been working with JAXA to promote open innovation in the space business and bringing together a diverse range of space business players since 2018.

## Accumulation of space-related clusters in the Nihonbashi area

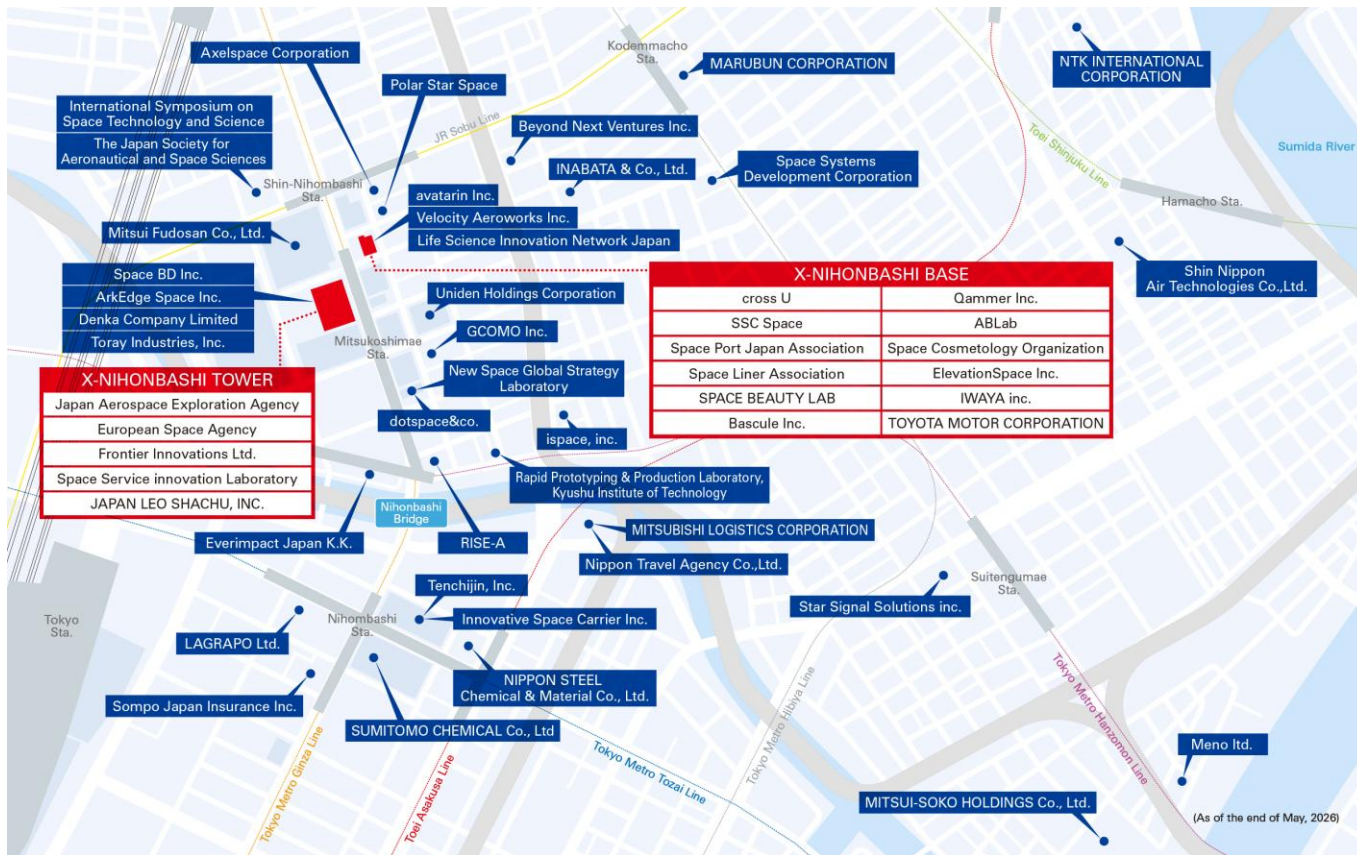

## Transportation

### From Nihonbashi

Mitsukoshimae Station

Shin-Nihonbashi Station

Directly connected to Nihonbashi Mitsui Tower

Nihonbashi Station

About 8 minutes' walk from Nihonbashi Mitsui Tower

To Otemachi Station	About 1 minute	Use Mitsukoshimae Station on the Tokyo Metro Hanzomon Line
To Roppongi Station	About 14 minutes	Use Mitsukoshimae Station on the Tokyo Metro Ginza Line and transfer to the Hibiya Line at Ginza Station
To Shibuya Station	About 18 minutes	Use Mitsukoshimae Station on the Tokyo Metro Hanzomon Line
To Akihabara Station	About 3 minutes	Use Mitsukoshimae Station on the Tokyo Metro Ginza Line and transfer to the JR Yamanote Line at Kanda Station
To Kasumigaseki Station	About 7 minutes	Use Mitsukoshimae Station on the Tokyo Metro Ginza Line and transfer to the Hibiya Line at Ginza Station
To Shinagawa Station	About 15 minutes	Use the direct access from Nihonbashi Station on the Toei Asakusa Line to the Kaitoku Keihin Kyuko Line
To Yokohama Station	About 36 minutes	Use Shin-Nihonbashi Station on the JR Sobu Rapid Line
To Haneda Airport Station	About 38 minutes	Use the direct access from Nihonbashi Station on the Toei Asakusa Line to the Kaitoku Keihin Kyuko Line
To Narita Airport Station	About 64 minutes	Use the Airport Kaitoku Express from Nihonbashi Station on the Toei Asakusa Line

### From Tokyo

Tokyo Station

About 8 minutes' walk from Nihonbashi Mitsui Tower

To Nagoya Station	About 97 minutes	Use the Tokaido Shinkansen Nozomi
To Shin-Osaka Station	About 147 minutes	Use the Tokaido Shinkansen Nozomi
To Sendai Station	About 90 minutes	Use the Tohoku Shinkansen Hayabusa

(Travel time only)

Various events and programs to promote the expansion of the space business are held about 300 times a year,\* and cooperation and co-creation among special members are actively pursued.

\* Actual track record for FY 2023

## ■ Nihonbashi Space Week

One of Asia's largest space business events, held annually since 2021.

In the Nihonbashi area, where many space players are clustered together, various events are held intensively, including business exhibitions, conferences of various sizes, contests, and networking.

# NIHONBASHI SPACE WEEK

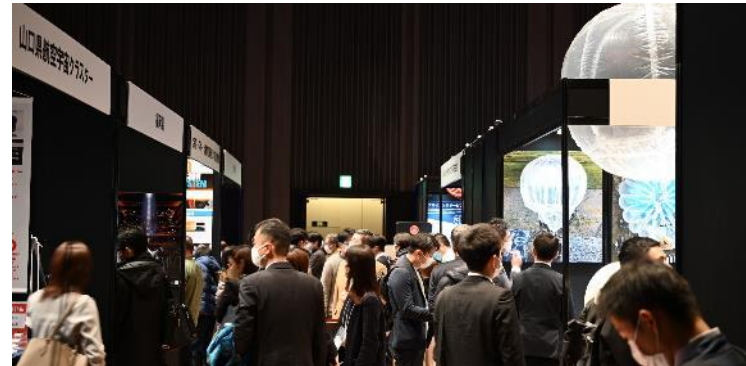

## Networking events



## Business matching events

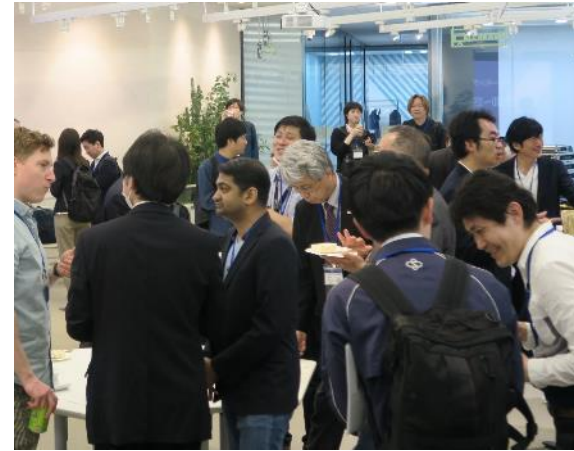

## Seminars and symposiums



## Space business courses

**Overview of space development utilization and space business and basics of satellite design**

**Course schedule** From December 2023 to February 2024  
Total of 6 sessions: 19:00-20:30

**Venue** X-NIHONBASHI BASE  
3rd Floor, Nihonbashi IT Building, Nihonbashi, Muromachi 3-3-9, Chuo City, Tokyo Metropolis

Organized by cross U

cross U Academy:  
Lectures in space development and business by guest experts





We are expanding our international network .

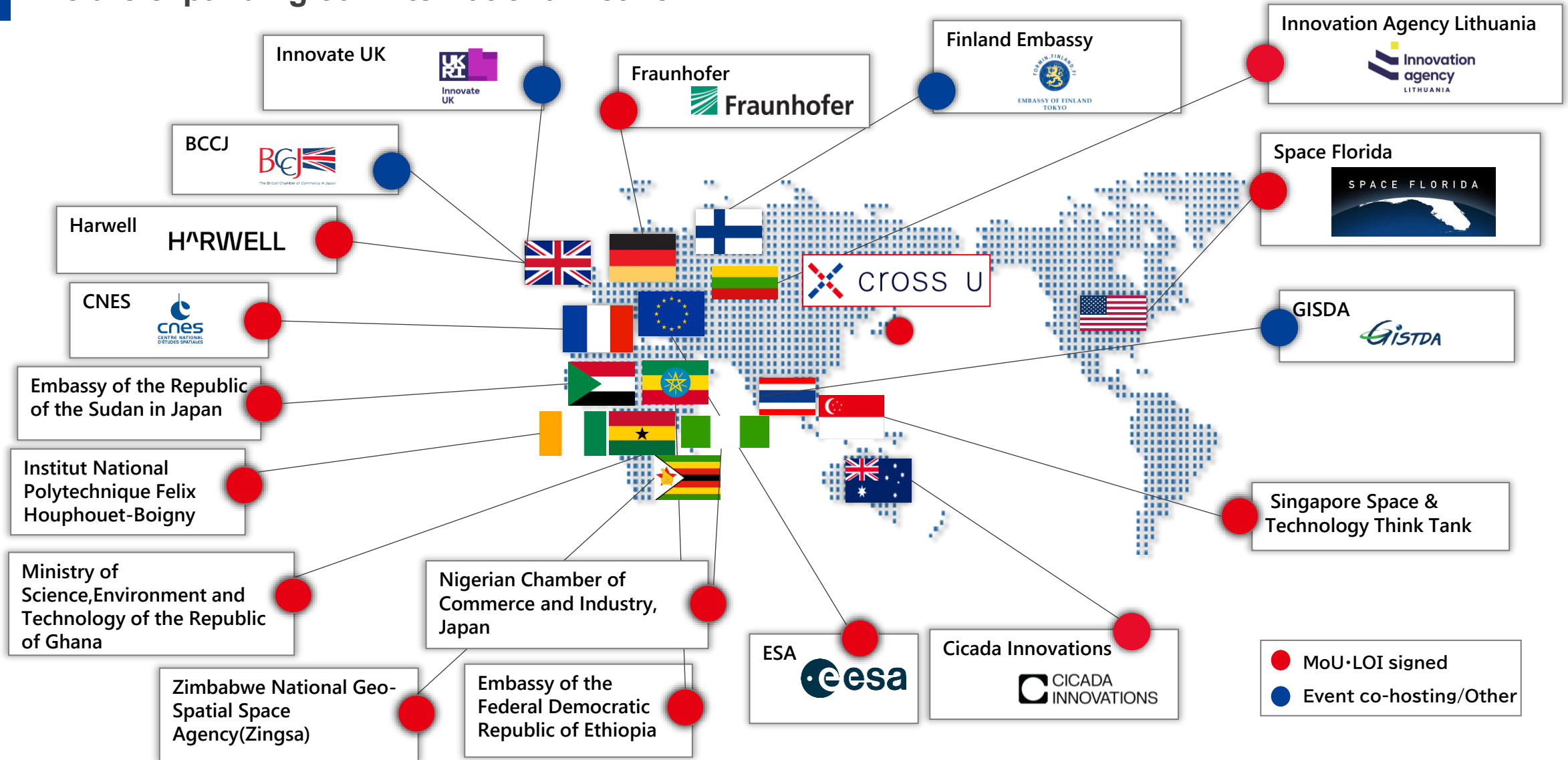

※As of November 2025

The committee includes representatives from a diverse range of organizations, including long-established corporations and academic institutions.

## Directors and Auditors

President of the Board	Shinichi Nakasuka	Professor, Research Organization of Science and Technology, Ritsumeikan University
Vice-President of the Board	Kazunori Yamashita	Executive Managing Officer, Appointed Chief Operating Officer, Innovation Promoting Division, Mitsui Fudosan Co., Ltd.
Director	Shuzo Takada	Corporate Vice President, FUJIFILM Corporation Former Director General of National Space Policy Secretariat, Cabinet Office (NSPS)
Director	Nobuyuki Fujisawa	General Manager, Space Business Innovation Department Innovation Promoting Division, MITSUI FUDOSAN CO., LTD.
Auditor	Yutaro Kikuchi	Attorney at law, Kikuchi Sogo Law Office
Auditor	Shigeru Sugimoto	CEO, Crowe Sakura & Co.

## Secretariat

Secretary-General	Masafumi Yonazu
-------------------	-----------------

## Administrative Advisory Committee

Tohru Akaura	General Partner & Co-Founder, Incubate Fund Co., Ltd. Special Advisor, Japan Venture Capital Association.
Masayasu Ishida	President and CEO, SPACETIDE Foundation
Seiji Izumisawa	Chairman of the Board, Mitsubishi Heavy Industries, Ltd.
Takashi Ueda	President and Chief Executive officer, Mitsui Fudosan Co., Ltd.
Shin Okuno	Vice President, Japan Aerospace Exploration Agency (JAXA)
Naoto Kadowaki	Principal Researcher, National Institutes of Information and Communications Technology
Kenji Goto	President, COO, Japan Space Systems
Mengu Cho, Ph.D.	Professor, Department of Space, Semiconductor and Mechatronics Engineering, Chiba Institute of Technology
Saku Tsuneta, Ph.D.	Director Astronomy Research Center, Chiba Institute of Technology
Shinji Tokumasu, Ph.D.	Vice President, National Institute of Advanced Industrial Science and Technology
Shohei Nomura	General Manager, Digital Infrastructure Business Solutions Department, Social Infrastructure Business Solutions Division, NEC Corporation
Tsugio Mitsuoka	Director, IHI
Naoki Murakami	Senior General Manager, Space Systems Division, Defense & Space Systems Group, Mitsubishi Electric Corporation
Naoko Yamazaki	Astronaut, Representative Director, Space Port Japan Association
Dr. Hiroo Yugami	Executive Vice President for the Science Park, Disaster Reconstruction and Regeneration, and Nano Terasu Co-creation, Tohoku University
Toshiya Watanabe	Vice President, Institute of Science Tokyo

We have startup CEOs and researchers who are experts in the space business supporting our activities.



**Hidetaka Aoki**  
Space Business Evangelist  
Partner, Global Brain Corporation  
Director, Space Port Japan Association



**Yoshifumi Inatani**  
Representative Director,  
Space Liner Association



**Fuminori Kataoka**  
Project General Manager,  
Digital Transformation Promotion  
Dept. Digital & Information  
Communication Group,  
Business Development Dept,  
New Business Planning Div.  
TOYOTA MOTOR CORPORATION



**Tomoya Nakamura**  
Representative Director and CEO,  
Axelspace Corporation



**Takayoshi Fukuyo**  
CEO and Representative Director,  
ArkEdge Space Inc.



**Yuichi Yamaura**  
President, Space Business  
Consultancy, Vision Y  
Visiting Professor, University Tsukuba  
Ex-Vice President, Japan Aerospace  
Exploration Agency (JAXA)



**Masatoshi Nagasaki**  
Co-Founder & CEO,  
Space BD Inc.



**Satoshi Kurosu**  
President,  
Cross Space &  
Sustainability, LLC



**Souichiro Kozuka**  
Professor,  
Faculty of Law,  
Gakushuin University



**Naohiko Kotake**  
Professor,  
Graduate School of System  
Design and Management,  
Keio University



**Seiko Shirasaka**  
Professor,  
Graduate School of System  
Design and Management,  
Keio University



**Kojiro Hatada**  
President and CEO,  
Innovative Space Carrier Inc.



**Naomi Kurahara**  
Co-Founder and CEO,  
Infostellar Inc.



**Toshinori Kuwahara**  
Associate Professor,  
Department of Aerospace  
Engineering,  
Graduate School of Engineering,  
Tohoku University



**Hiroshi Koyama**  
Chief Technical Officer,  
Defense & Space Systems  
Sector,  
Mitsubishi Electric Corporation



**Yasutoshi Hyakusoku**  
Director & Head of Technology Strategy,  
Tenchijin, Inc.



**Akira Fukabori**  
Representative Director and  
CEO,  
avatarin Inc.



**Ayako Matsumoto**  
Manager, Space Business  
Development - Corporate  
Strategy  
ANA HOLDINGS INC.



**Teruo Yamashita**  
Board Director, Managing Executive Officer,  
Unit President,  
Space Business Unit,  
SKY Perfect JSAT Corporation



**Michael Fletcher**  
President and CEO,  
MJF Consulting LLC



**Koichi Wakata**  
Astronaut  
Chief Technology Officer,  
Axiom Space

## Special member **A**



### Corporations

Companies with 301 or more employees

## Special member **B**



### Academia, startups, public organizations, etc.

Non-profit organizations,<sup>\*2</sup> universities, school corporations, public interest corporations, diplomatic missions in Japan, local governments, etc.

## Special member **C**



### Individuals

Use of X-NIHONBASHI facilities<sup>\*3</sup>

- Use of co-working spaces, bar lounge, etc.
- Occupancy use of co-working spaces, bar lounge, etc. (events, etc.)
- Gallery exhibitions
- Use of conference spaces

- Use of co-working spaces, bar lounge, etc.
- Gallery exhibitions
- Use of conference spaces

Registration fee

50,000 yen

20,000 yen

2,000 yen

Annual Membership fee

250,000 yen

60,000 yen

5,000 yen

Number of Bitkey accounts

10<sup>\*4</sup>

5<sup>\*5</sup>

1<sup>\*6</sup>

\*1. The number of full-time employees.

\*2. Excluding Incorporated Administrative Agencies, National Research and Development Agencies, and Administrative Agencies (local governments).

\*3. X-NIHONBASHI facilities are available from 8:00 to 19:00.

Additional fees will be charged separately for full, partial, and occupancy use of the facilities. Please refer to the separate document for details.

\*4. Up to 10 additional keys can be issued for a fee.

\*5. Up to 5 additional keys can be issued for a fee.

\*6. X-NT fixed-lease tenants (≠ Nihonbashi members) have no limit on the number of accounts that can be issued.

		Special member A/B	Of which, Nihonbashi members*1	Special member C
Co-working spaces: TOWER/BASE	Use*2	Available	Available	Available
	Occupancy*3	Up to <b>4 times a year at each location</b> Reservation possible <b>3 months in advance</b>	Up to <b>12 times a year at each location</b> Reservation possible <b>6 months in advance</b>	Not available
Bar lounge: BASE	Use*2	Available	Available	Available
	Occupancy*3	Up to <b>4 times a year</b> Reservation possible <b>1 month in advance</b>	Up to <b>12 times a year</b> Reservation possible <b>2 months in advance</b>	Not available
Use of conference spaces		Free of charge up to <b>30 hours/month</b> After that, 250 yen/10 min	Free of charge up to <b>50 hours/month</b> After that, 250 yen/10 min	Free of charge up to <b>30 hours/month</b> After that, 250 yen/10 min
Use of Meeting Space 002 (TOWER, reservation not possible, no doors)		Available	Available	Available
Gallery exhibitions (BASE)		<b>Available up to twice a year in 2-week periods</b>	<b>Available up to 5 times a year in 2-week periods</b>	Not available
Shared rooms: 4 rooms*4		Separate contract with Mitsui Fudosan required (Membership registration required) 31,000 yen (monthly, excluding tax)	Same as on the left	Not available

X-NIHONBASHI facilities are available for use from 8:00 to 19:00, except for the shared rooms. Additional fees will be charged separately for full, partial, and occupancy use of the facilities. Please refer to the separate document for details.

- \*1. Companies with space-related business divisions based in the Nihonbashi area are eligible.
- \*2. May not be available during events, etc.
- \*3. There is a pre-screening process for using the co-working spaces for events. We also ask that you refrain from using the spaces for commercial purposes.
- \*4. Please refer to the next page for information on the shared rooms.

Shared rooms are available at X-NIHONBASHI BASE for unlimited use by the hour, and can be used for meetings, etc.

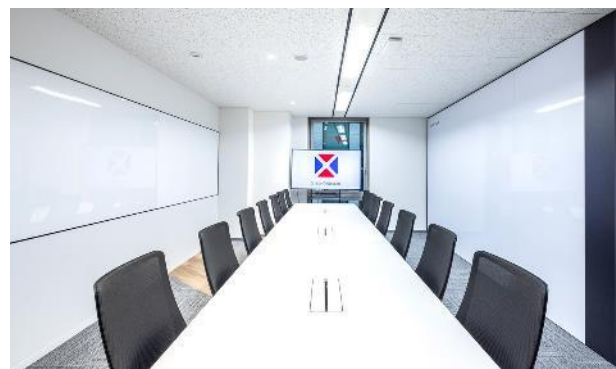
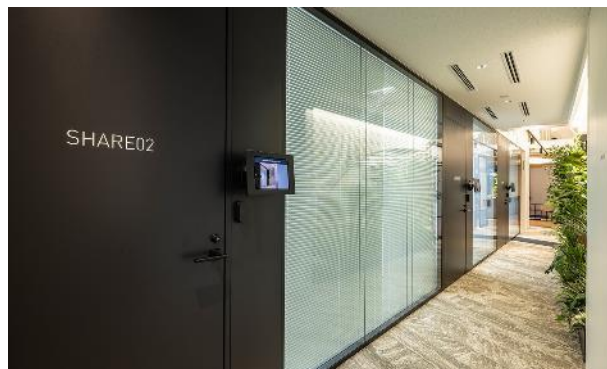

Note:

- To use this service, a separate contract with Mitsui Fudosan is required in addition to becoming a cross U member.
- Additional fees will be charged for the use of shared rooms.
- The use time is unlimited. (A reservation must be made via the dedicated website to use them.)
- Registration as a corporation is also available upon request.

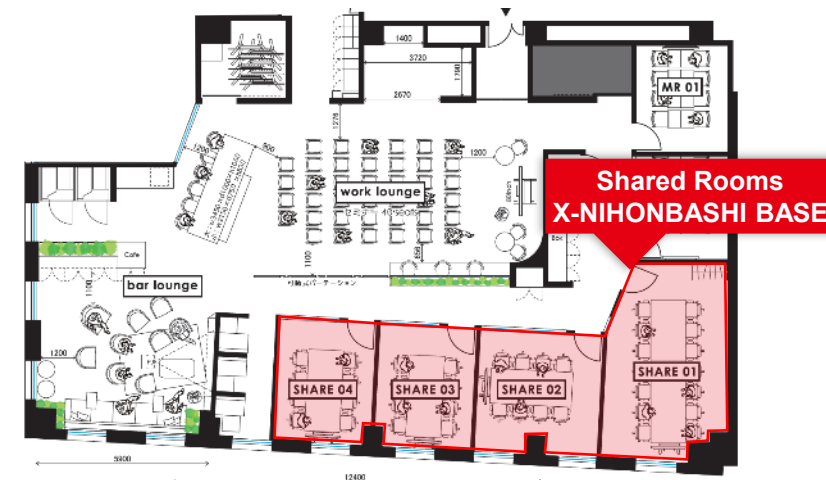

SHARE 01	30.00 m <sup>2</sup>	14 people
SHARE 02	19.50 m <sup>2</sup>	8 people
SHARE 03	15.57 m <sup>2</sup>	8 people
SHARE 04	15.38 m <sup>2</sup>	8 people

- Open hours: 24 hours a day, including Saturdays, Sundays, and national holidays (except when the facility is closed)
- Rental equipment: 1 monitor  
1 table  
8 chairs  
1 whiteboard
- Amenities: Power supply Wi-Fi

(As of April 2023)

Note: Please be aware that the equipment and amenities are subject to change without notice.

